



# PG • industri

*Alt í spántagníng*

- CNC milling
- CNC turning
- Swiss-type lathe

# OUR COMPANY

## Proven Experience:

A decade and a half of industry-proficiency.

## Adaptable Production:

Tailored flexibility to meet dynamic market demands.

## Enduring Partnerships:

Committed to fostering long-term client relationships.

## Volume Mastery:

Exceptionally equipped for high-volume production runs.



# OUR SERVICES

- CNC milling
- CNC turning
- Swiss-type lathe

“ We are specialised in CNC turning and milling on a big scale with a high rate of automation



# QUALITY ASSURANCE

We clean our components in a fully automatic washing system using alcohol.

We have zero percent complaints for the last 2 years.

We have traceability on the materials from raw material to finished product.



# PRODUCT SAMPLES

We can produce more than 3 million components in one design per month.

“ We can produce components from  $\varnothing 1$  mm to  $\varnothing 250$  mm and milling from 1000 mm x 1000 mm

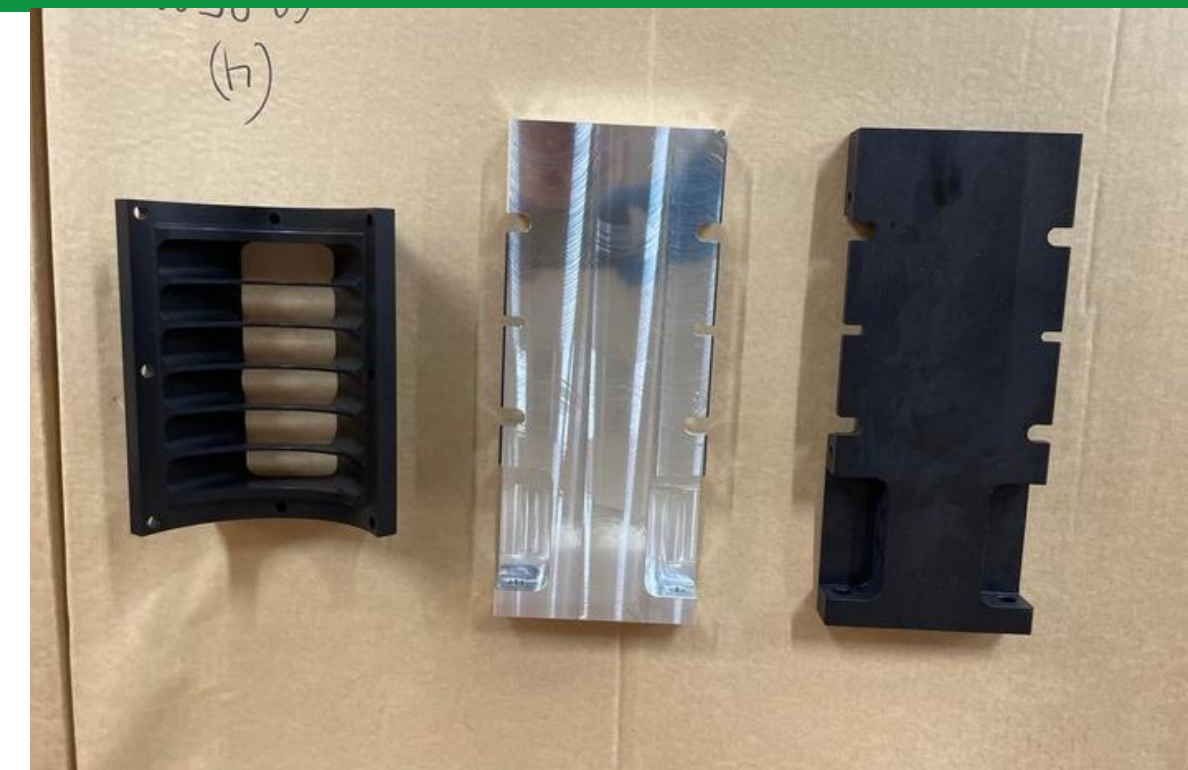

# RECYCLE

We recycle all our chips and residual materials.

We separate all the oil from the chips, filter it, and recycle it for reuse.

We clean up spilled oil from the floor and wring it out of the cloths so it can be recycled.



# OUR FUTURE PLANS

“ Our plans for the next three years include expanding our production capacity by adding an additional 1 400 square meter production hall.

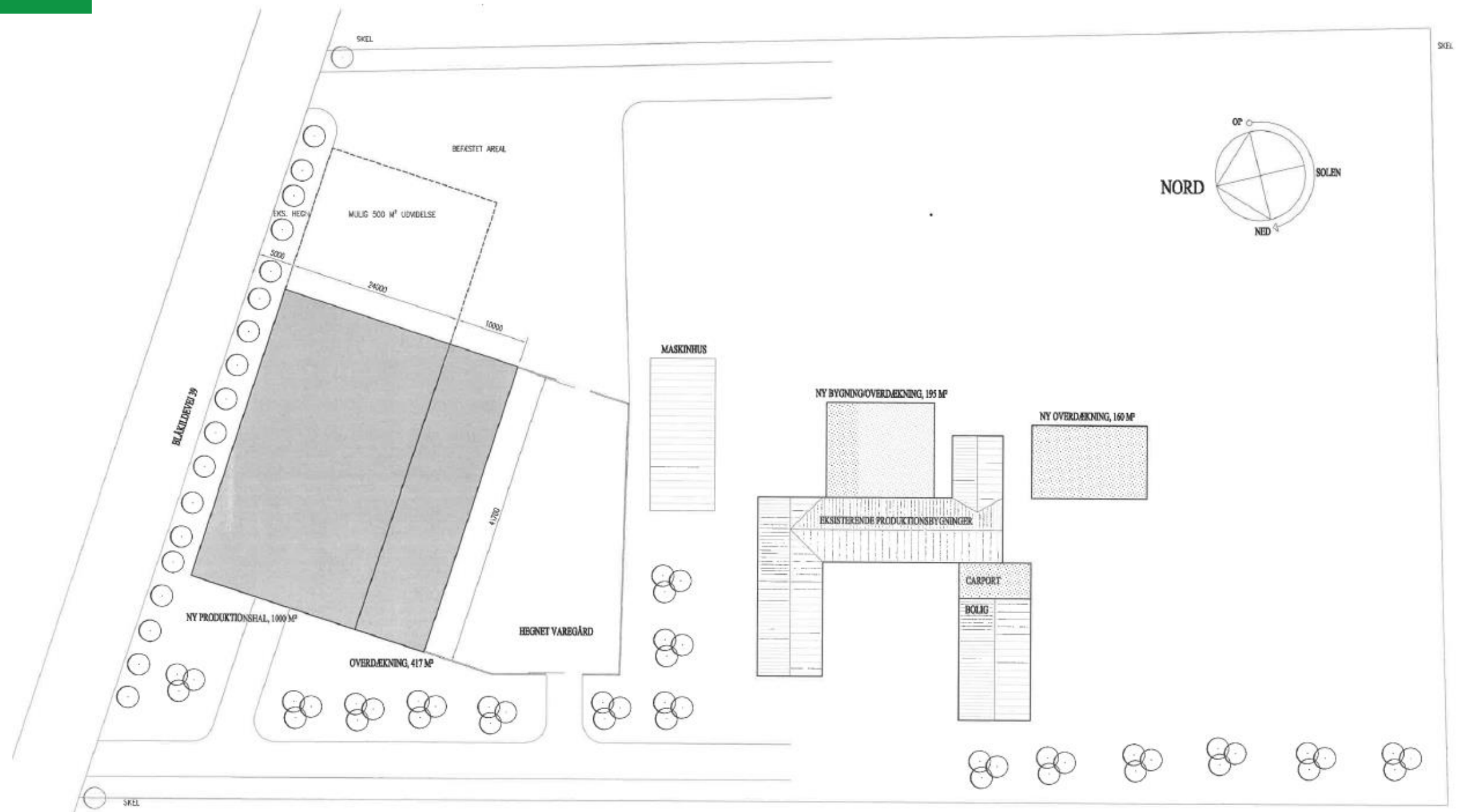

# THANK YOU!



[pg@pgindustri.dk](mailto:pg@pgindustri.dk)



+45 20 40 63 58

